



S





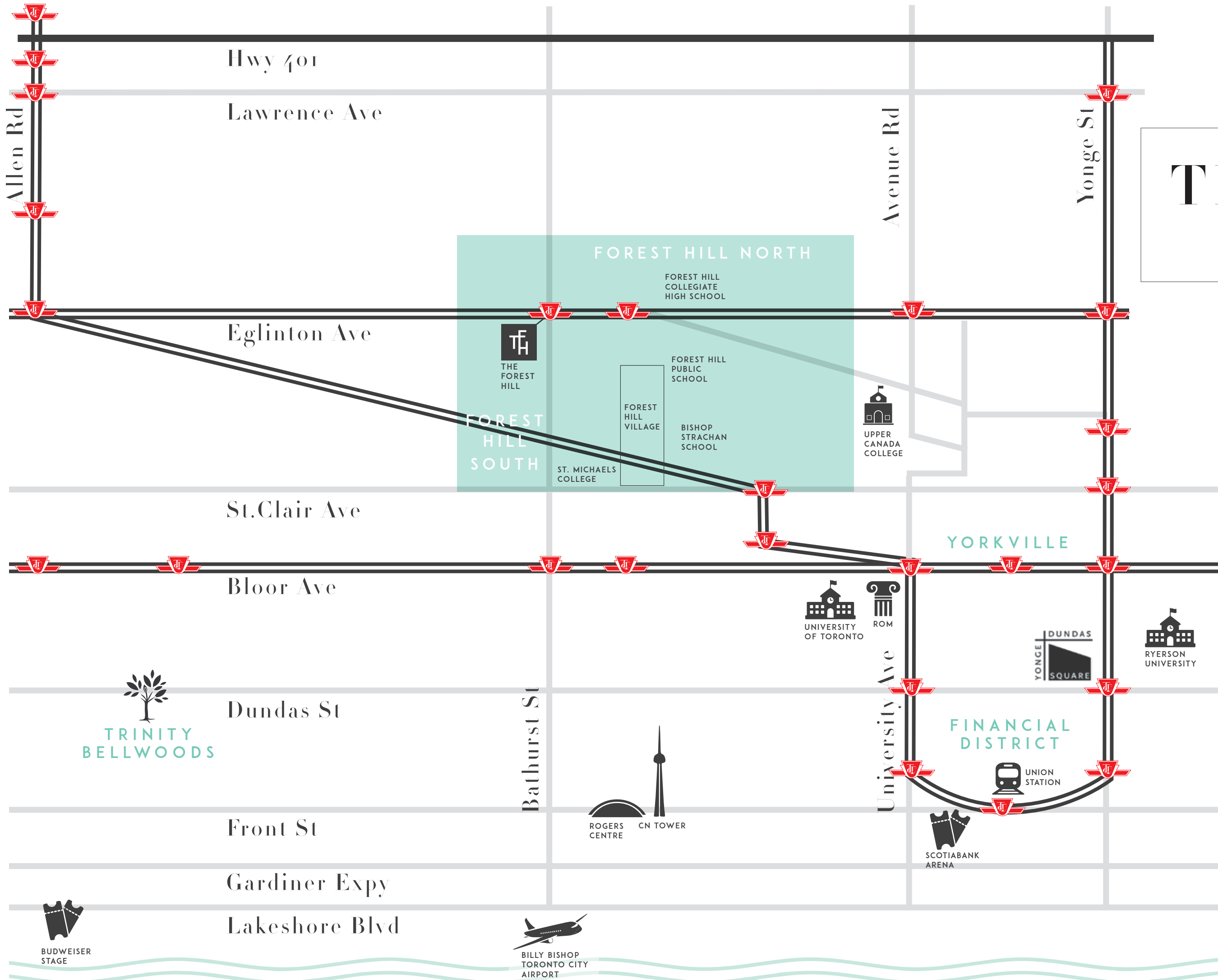

FOREST HILL

THIS IS...

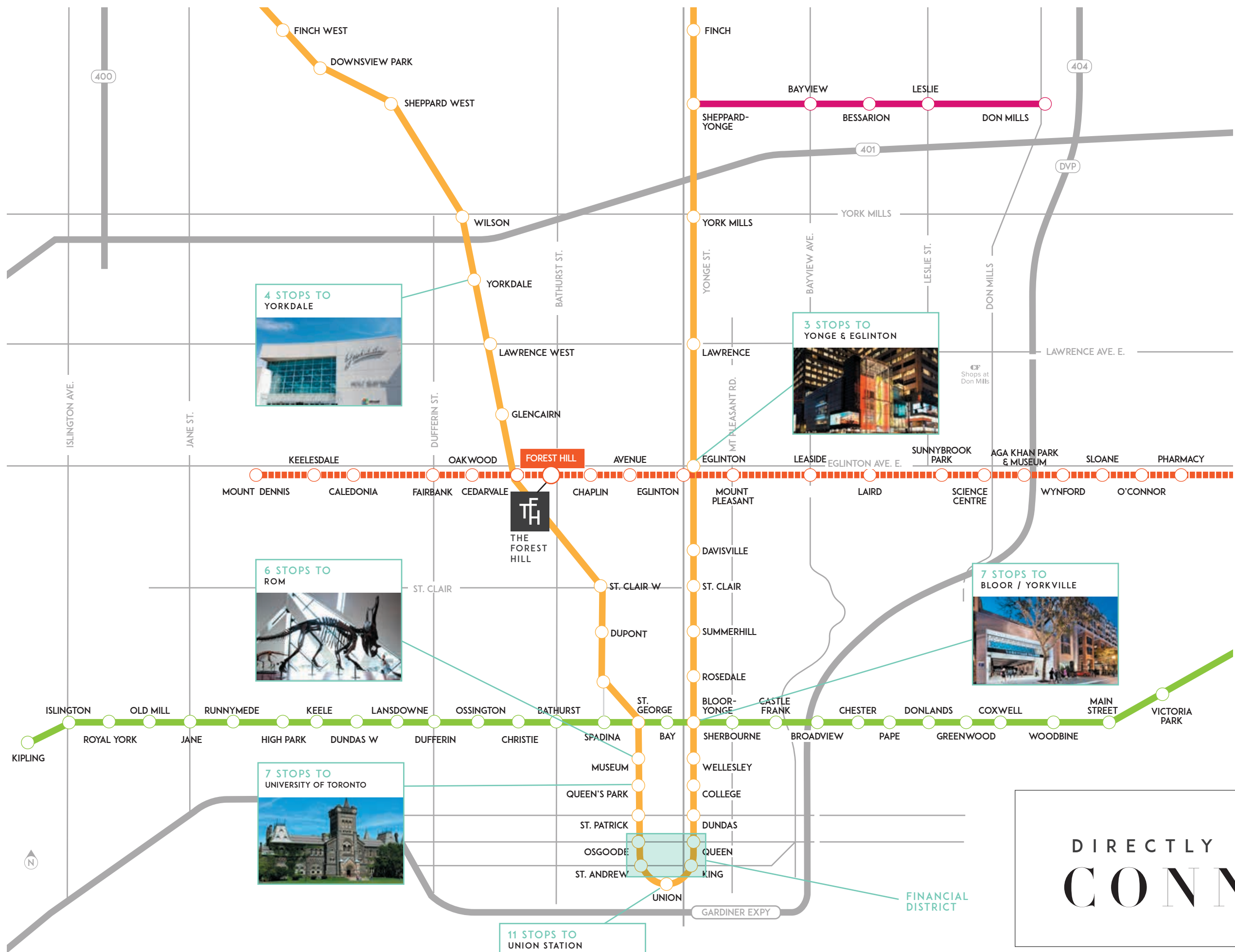
FOREST HILL





-  YONGE-UNIVERSITY LINE
-  EGLINTON LINE
-  BLOOR-DANFORTH LINE
-  SHEPPARD LINE

DIRECTLY
CONNECTED.

THIS IS FOREST HILL



DIRECTLY CONNECTED.

THIS IS FOREST HILL

Connect to the buzz of the city from one of the most sought-after neighbourhoods. The Forest Hill makes it all possible, in an ultra-stylish midrise at the intersection of Bathurst and Eglinton, the home of the Forest Hill subway station. Live and play in one of Toronto's toniest areas, surrounded by all things urban. With a direct subway connection in your lobby, access to the entire city is at your doorstep. Who says you can't have it all?

L O B B Y



Illustration is artist's concept.

The grand two storey lobby furnished by the house of Armani, The Forest Hill is imbued with a sense of sophistication and unapologetic style.

LOBBY (GROUND FLOOR)

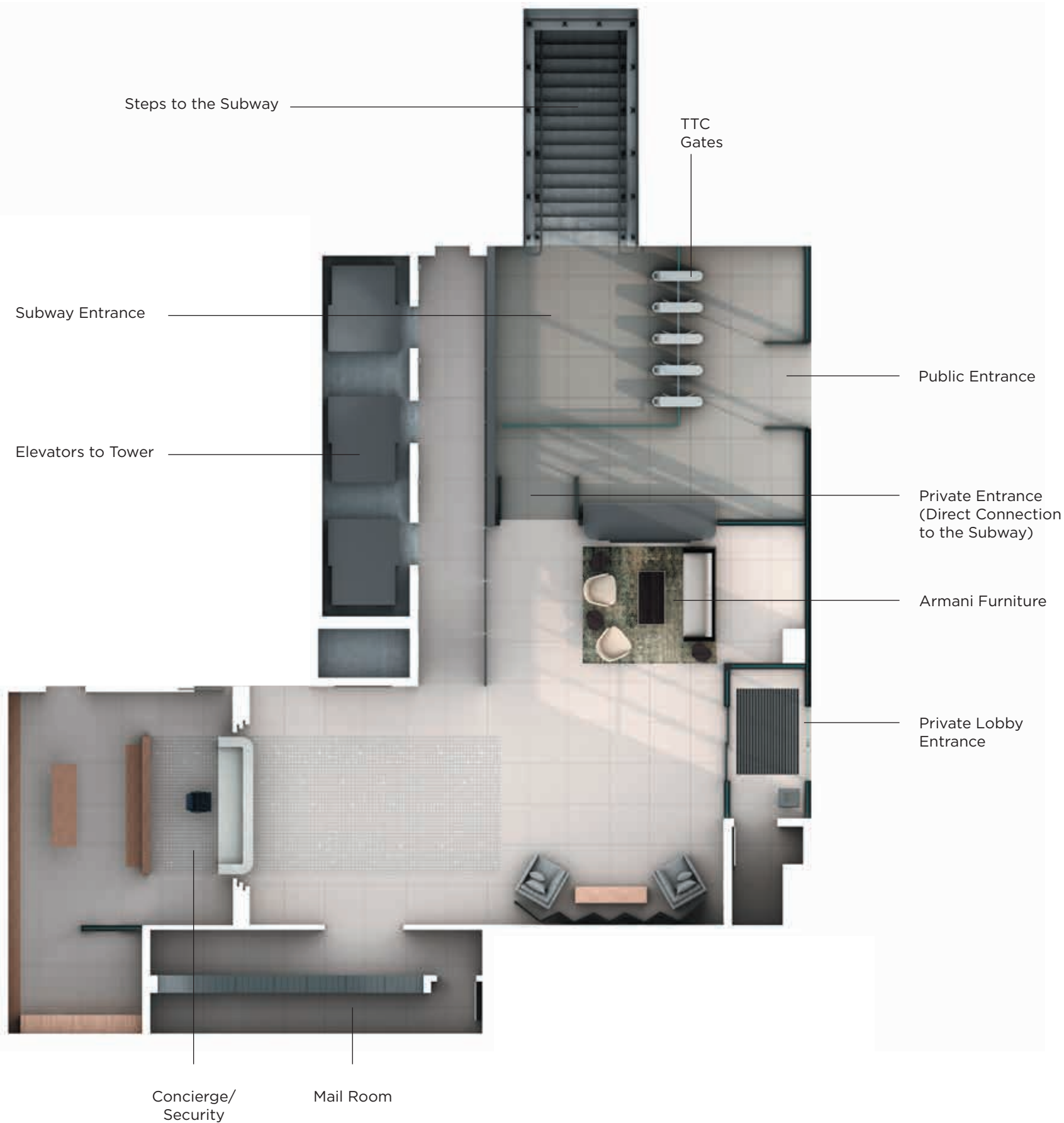

Lobby furnished by Armani

As you step into The Forest Hill lobby a palette of elegantly blended soft neutrals and pastels welcome you home. The Armani furniture is tailored with classically sculptured curves that form a serene atmosphere which creates a distinct departure from the bustling streetscape of Eglinton Avenue.



Illustration is artist's concept.



AN ADDRESS IN TORONTO'S

MOST DESIRABLE NEIGHBOURHOOD



THIS IS FOREST HILL

All the pedigree of a Forest Hill address, all the urban must-haves you need. Stroll along Eglinton and linger in luxury boutiques and some of the city's best-known restaurants. Wander further into the neighbourhood to discover its quiet green spaces and highly coveted public and private schools. Want to venture further afield? Direct subway access through the lobby connects you to everything the city has to offer.

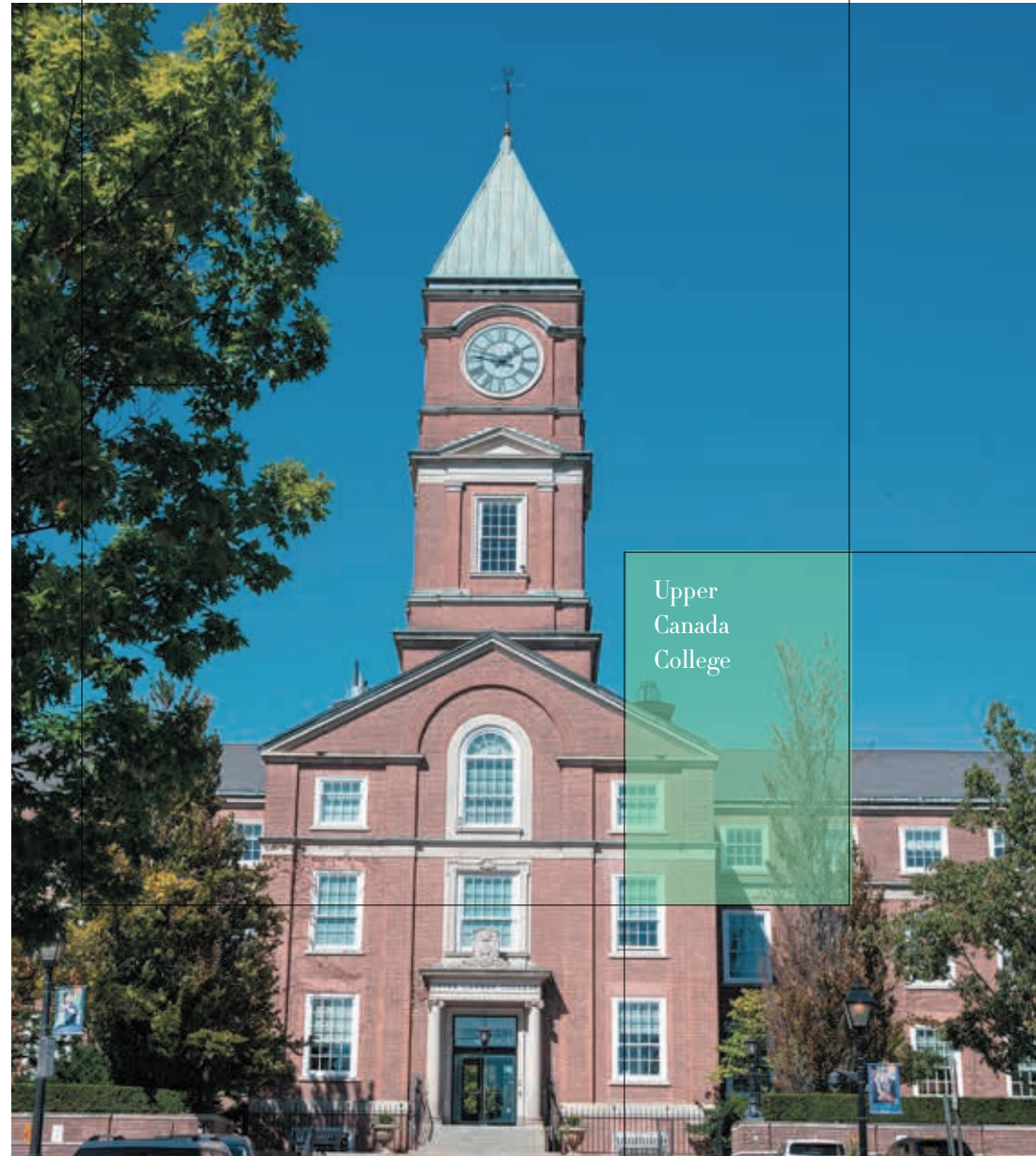

Upper
Canada
College

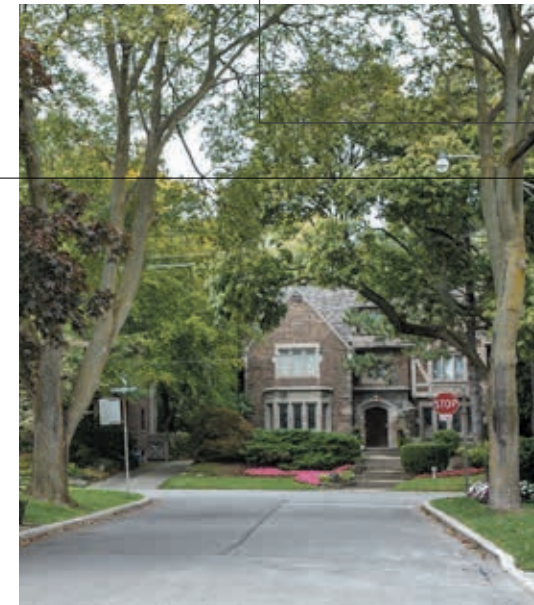

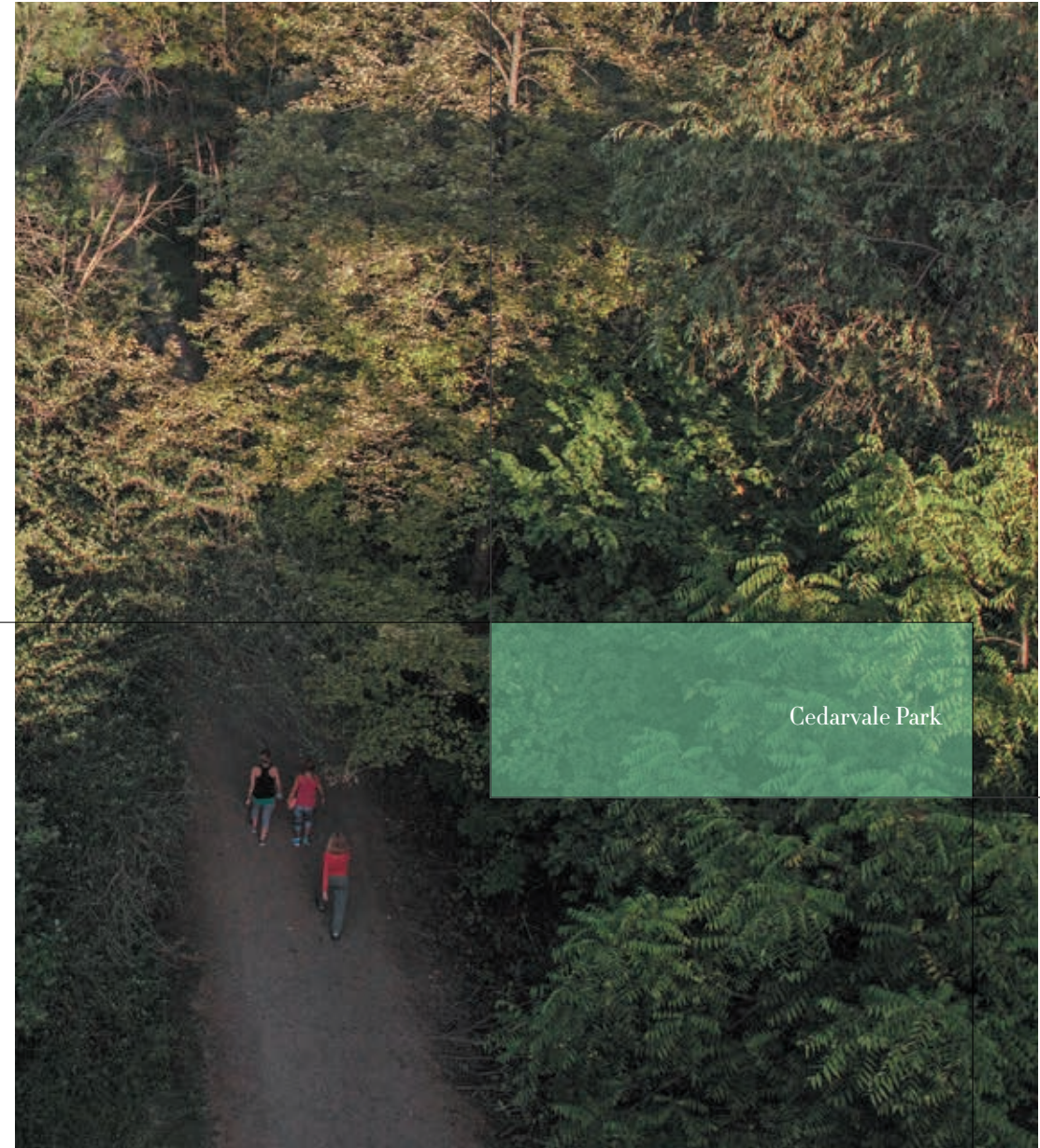

Cedarvale Park



THE
BUILDING



TIMELESS DESIGN.

THIS IS FOREST HILL

Rising 14 storeys above the bustling Eglinton streetscape, The Forest Hill creates an iconic statement in the city's skyline. Metal clad exteriors present in three eye-catching monochromatic palettes, while inset balconies and terraces, a ninth level podium and a stunning canopied entrance add to the striking silhouette. The result is bold, yet elegant. Design-forward, in just the right measure. After all, your address is a reflection of you.

Illustration is artist's concept.

360° VIEW FROM PENTHOUSE LEVEL

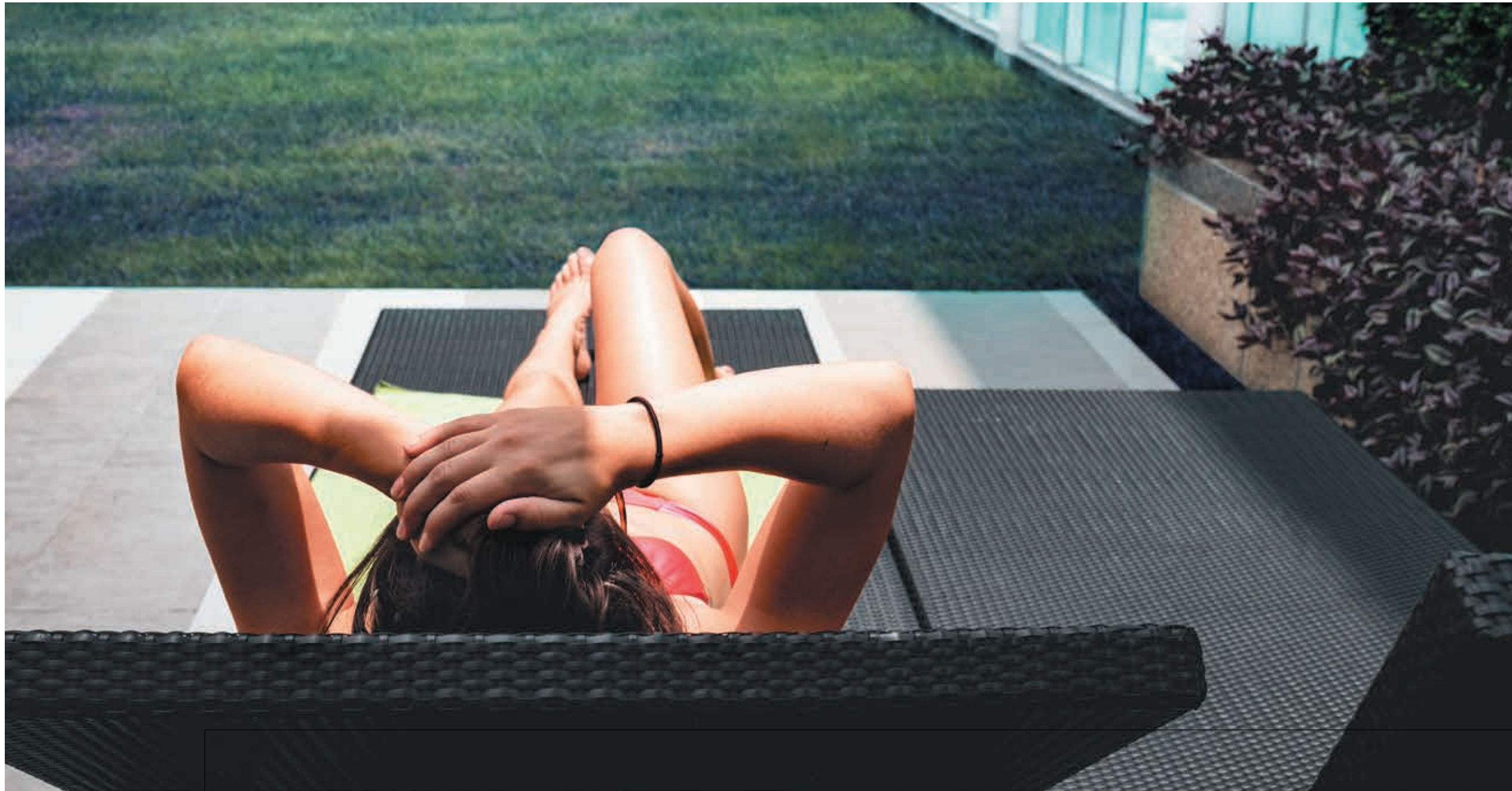



Illustration is artist's concept.



THE
AMENITIES



LIFE AND WORK CONNECTED.

THIS IS FOREST HILL

There's a concierge on duty 24/7 to help your day-to-day flow seamlessly, a zen yoga studio for your practice, and even a shared workspace thoughtfully designed to accommodate both privacy and social gatherings – with a vibe similar to that of an upscale café. At an address of this stature, would you expect anything less?

COWORKING SPACE



Illustration is artist's concept.

**COWORKING SPACE
+ OUTDOOR LOUNGE
(LEVEL 10)**



Illustration is artist's concept.

G Y M



Illustration is artist's concept.



GYM + OUTDOOR ACTIVITIES (LEVEL 2)

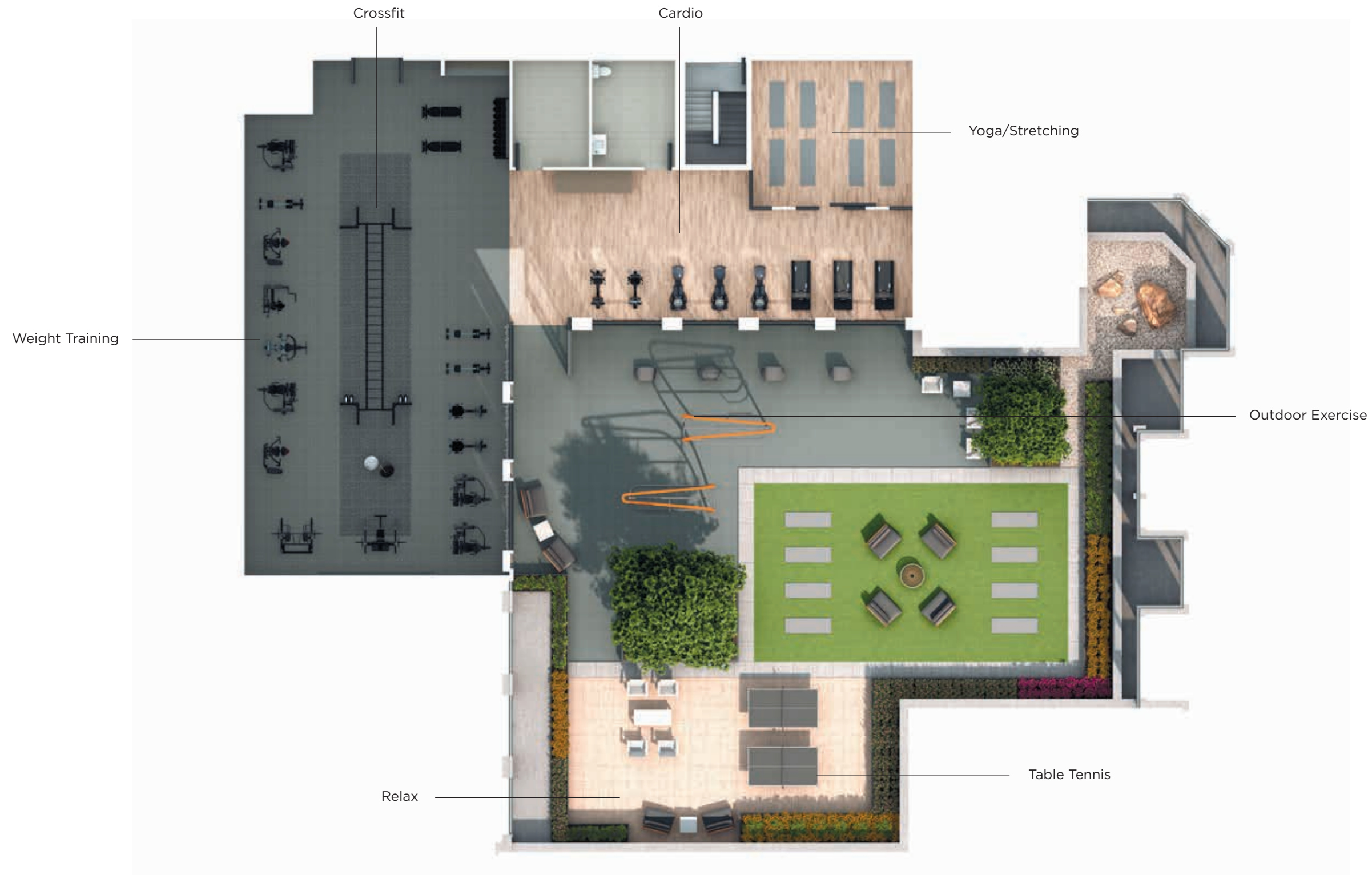

Illustration is artist's concept.



THE SUITES

LIVING SPACES DESIGNED FOR
LIVING WELL

THIS IS FOREST HILL

The perfect antidote to the nonstop pulse of the city? A masterfully designed retreat. The Forest Hill leaves no detail unconsidered: floor-to-ceiling windows bathe each studio, 1, 2 or 3 bedroom suite in light, while 9' ceilings and open concept design create a seamless sense of space. Ensuites are spa-inspired, kitchens are chef-infused, living spaces are decorator-imagined. Exceptional features and finishing details.



S U I T E A



Illustration is artist's concept.



S U I T E C



Illustration is artist's concept.

S U I T E B



Illustration is artist's concept.



BUILDING

- 24 hour, 7 day a week concierge
- Security coded access fob for all residents
- Two guest suites provided for residents use
- Individual suite hydro, BTU and water metering
- Automated parcel storage

SUITES

- Ceiling heights of approximately 9' in principal rooms (concrete slab to slab) except in areas with dropped ceilings and bulkheads
- Smooth finished ceilings throughout
- Choice of flooring throughout entry, kitchen, dining, living areas and bedrooms from builder's standard samples
- Painted baseboards, door frames and casings
- TV/telephone outlets in living/dining room and bedrooms
- Smoke detectors and sprinkler system

KITCHENS

- Kitchen cabinetry from builder's standard samples
- Composite stone countertop from builder's standard samples
- Undermount stainless steel sink

Appliances Collection

- Refrigerator
- Range
- Microwave
- Exhaust Fan Insert
- Dishwasher
- Stacked washer and dryer
- Wine fridge available only in certain suites

BATHROOMS

- Composite stone countertop from builder's standard samples
- Tile from builder's standard samples
- Sink and faucet
- Bathroom cabinetry from builder's standard samples
- Bathtub with shower curtain rod, faucet, controls and shower head, as per plan
- Shower with enclosure, as per plan

EXCEPTIONAL FEATURES...

AND FINISHING DETAILS

THIS IS FOREST HILL

Features and finishes are subject to change without notice. E. + O.E.

COLLABORATIVE EFFORTS WITH INSPIRED PARTNERS

A PROLIFIC DEVELOPER WITH DEEP EXPERIENCE

THIS IS FOREST HILL

CENTRECOURT is known for its well thought out developments. Always close to major amenities, rapid transit network and employment areas, its numerous high-rise condominiums are designed for modern city life. The company believes that this approach to development will contribute to the GTA's vibrancy, sustainability and competitiveness. CentreCourt has completed or is actively developing 15 high-rise residential communities throughout the GTA, collectively representing over 7,000 homes and \$3.5 billion dollars of development value. Driven by its vision to become industry leaders, CentreCourt values excellence and aims to create a positive impact in the way people live. It takes pride in building unique developments and strives to exceed customer expectations. All its developments are collaborative endeavours undertaken with top rated planners, architects, interior designers and construction trades. CentreCourt was behind the most successful condo launches of 2011, 2012, 2014, 2015, 2016, 2017 and 2019 with Peter Street Condos, Karma Condos, INDX Condos, Core Condos, Grid Condos, 411 Church Condos, Transit City and TC4+5.

Quadrangle Architects

Quadrangle is a design studio of over 200 people. They have been serving the business needs of their clients for more than 30 years, working across a diverse set of sectors, realizing visions big and small. Their projects innovate on tested ideas, create accessible communities, and reinvent old spaces. Quadrangle balance creativity with in-depth business expertise to solve challenges, continually building and evolving lasting relationships through the successful delivery of legacy projects.

Quinn Design Associates

Established in 1987, Quinn Design Associates creates inspiring spaces that respond to the needs of the people who use them. Based in Toronto, the firm's dedicated team of professionals has proven expertise in urban and public space design, effective project delivery, as well as both current and innovative installation materials and methods. Quinn's portfolio of successfully built work both in Ontario and internationally includes a diverse range of project types: from multi-unit residential developments, retail centres, and offices to educational, civic, and healthcare buildings.

Figure3

With 25 years of business success, figure3 is one of Canada's largest award-winning, independently owned interior design firms transforming how people work, live, and shop. Invoking brand strategy and its unique design research process, figure3 takes an in-depth look at the intersection of human behavior and client goals to rethink the physical environment, truly connecting people to place. Based in Toronto, figure3 is a studio of 60+ designers, and works with the world's most exciting and progressive companies. Notable projects include Sony Interactive Entertainment, Cineplex and Virgin Mobile, and prominent residential developments such as Transit City and The Well.

THIS IS